

PRECISION COMPACT HEAT GUN MJ-600

iroda

MICRO-THERM™

PROFESSIONAL QUALITY



WARNING

Important: Read these instructions for use carefully so as to familiarize yourself with the appliance before connecting it to its gas cartridge. Keep these instructions for future reference.

iroda PRECISION COMPACT HEAT GUN

MJ-600

SPECIFICATIONS

Dimensions	L 25 mm W 80 mm H 115 mm
Weight (w/o gas filled)	95g
Fuel	Butane
Running Time for Continuous Use	Approx. 20 Minutes
Hot Air Temperature	650°C

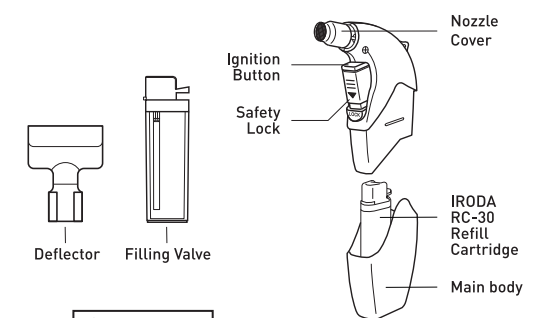

FEATURES

- Piezo electronic ignition system with safety lock.
- Powered by IRODA RC-30 refill cartridge.
- Hot air temperature up to 650°C.
- Compact size with heat deflector easy to use source of flameless heat whether you're working with shrinkable packing materials spot-drying paint, bending plastics/laminates or activating adhesives.
- New contoured design and trigger ignition button allow for a more comfortable grip.

REFILLING GAS

- For the best result use only Iroda RC-30 butane refill cartridge.
- Refill the gas in a well-ventilated area.
- Remove cartridge from the MJ-600. Insert the nozzle of butane canister into RC-30 refill valve at bottom of cartridge vertically.
- Press down on the butane canister until the gas starts to flow and wait for 5 minutes before use.

CAUTION:

- Use outdoors only or use in well ventilated areas.
- Read the instructions before using the appliance.
- Accessible parts may be very hot. Keep young children away from the appliance.

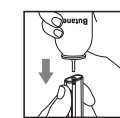

(Fig. 1)

HOW TO USE THE MJ-600

- Remove the upper body, then place the gas cartridge into the main body. Then, slide the two halves of the body back together. [Fig. 2]
- Switch the safety lock to the unlocked position. Then, slowly press the ignition button to the maximum point. Your tool is now fire up and ready to use. [Fig. 3]

Note:

If the tool does not glow red, adjust the regulator on the gas cartridge and press the ignition button again. As the gas in the lighter is consumed, the regulator will need to be adjusted periodically to ensure a proper heat.

- When the ignition button is released, there will be a short delay before flame is completely extinguished.
- When the tool is not in use, remove the gas cartridge.
- When shrinking tubing use deflector as shown in [Fig. 4].

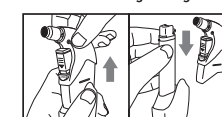

(Fig. 2)

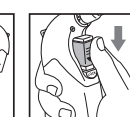

(Fig. 3)

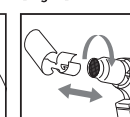

(Fig. 4)

WARNINGS

- KEEP AWAY FROM CHILDREN!
- Contains flammable gas under pressure. Be sure flame is out after use.
- Must cool down after 5 minutes of continuous burn.
- Do not touch nozzle cover while in use or before cool down.
- Keep ignited lighter away from face or clothing.
- Do not store above 50°C or to prolong sunlight.
- Do not use the appliance if it has damaged or worn seals.
- Do not use an appliance which is leaking, damaged or which does not operate properly.
- For outdoor use or use in a well-ventilated location in accordance with national requirements.
- For the supply of combustion air.
- And to avoid the dangerous building up of un-burnt gases for appliances not fitted with a flame supervision device.
- The appliance shall be operated on a horizontal surface, unless it is not intended to operate resting on a surface.
- The appliance shall be used away from flammable materials and information on minimum distances 1.5m from adjacent surfaces (wall, ceiling).
- If there is a leak on your appliance (smell of gas), take it outside immediately into a well-ventilated flame free location where the leak may be detected and stopped. If you wish to check for leaks on your appliance, do it outside. Do not try to detect leaks using a flame, use soapy water.
- Do not modify the appliance or try to fix it. Send the appliance back to a place you purchased.

ROUTINE MAINTENANCE OF THE APPLIANCE

- Cleaning the injector with solvent every 3 months or if necessary.
- Send the appliance back to place you purchased or contact manufacturer.



WARNING:
Cancer and Reproductive Harm-
www.P65Warnings.ca.gov

Designed & Manufactured
by Pro-Iroda Industries, Inc.



MADE IN TAIWAN



Pantone 1235C