

Brother TZe231

Brother Genuine P-touch TZE-231 Tape Instruction Manual

1/2" (0.47") Wide Standard Laminated Tape, Black on White

1. PRODUCT OVERVIEW

The Brother Genuine P-touch TZE-231 Tape is a high-quality, laminated label tape designed for use with Brother P-touch Label Makers. This tape features black print on a white background, offering excellent contrast and readability. Its durable construction makes it suitable for both indoor and outdoor applications.

Key Features:

- **Most Durable Labels Available:** Engineered for long-lasting adhesion, legibility, and ultimate durability.
- **Rigorous Testing:** Tested to withstand environments and temperatures ranging from freezing to boiling, resistant to fading from sunlight, abrasion, water, and many different chemicals.
- **Powerful 7-Layer Lamination:** Patented technology reinforces and protects the surface of labels, with text printed between layers for ultimate protection.
- **Secure Adhesion:** Superior adhesion allows labels to stay put even in dishwashers or microwaves, ideal for smooth or textured surfaces.
- **Versatile Options:** Available in a range of colors, sizes, and styles, including premium and specialty variants.



Figure 1.1: Brother Genuine P-touch TZE-231 Tape packaging, highlighting its indoor and outdoor use and resistance to various elements.

2. SETUP AND INSTALLATION

Installing the TZE-231 tape cassette into your compatible Brother P-touch Label Maker is a straightforward process. Ensure your label maker is powered off before proceeding.

Installation Steps:

1. Open the tape cassette cover on your P-touch Label Maker. The location of this cover may vary by model, but it is typically on the back or top of the device.
2. Gently insert the TZE-231 tape cassette into the designated slot. Ensure it clicks firmly into place. The tape should feed smoothly into the printer mechanism.
3. Close the tape cassette cover securely.
4. Power on your P-touch Label Maker. The device should recognize the newly installed tape.

P-touch

TZe-231

**Black Print on
White Label Tape**

↑
~1/2"
↓



**Laminated
Label Tape**

For use with P-touch
machines that use
~1/2" TZ & TZe tapes

Figure 2.1: A Brother TZE-231 tape cartridge, showing its internal components and 12mm width.

Surface Preparation:

For optimal adhesion and longevity, ensure the surface where the label will be applied is clean, dry, and free of dust, oil, or other contaminants. Using rubbing alcohol to clean the surface and allowing it to dry completely before application is recommended.

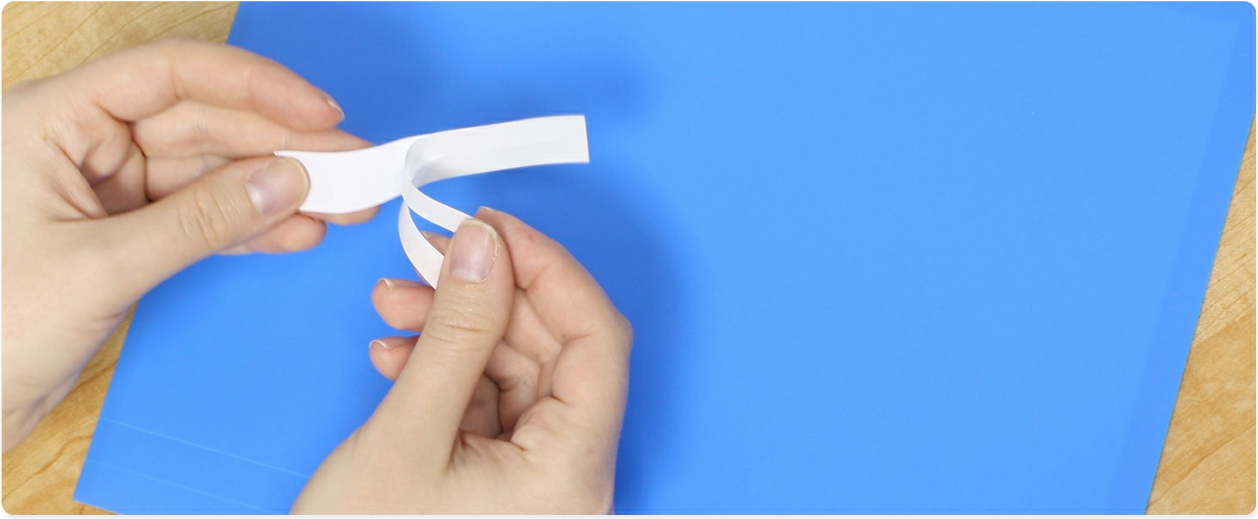

Figure 2.2: Hands demonstrating the easy-peel backing of a Brother P-touch label, facilitating smooth application.

3. OPERATING THE TAPE

Once the TZE-231 tape is installed, you can begin creating labels using your P-touch Label Maker. Refer to your label maker's specific instruction manual for detailed operating procedures, including text input, formatting, and printing functions.

Label Creation Tips:

- **Text Input:** Use the keyboard on your label maker to type the desired text.
- **Formatting:** Explore your label maker's features for different font sizes, styles (bold, italic, underline), frames, and symbols to customize your labels.
- **Printing:** Press the print button on your label maker. The label will be printed and dispensed. Most P-touch models have an automatic cutter.
- **Application:** Carefully peel the backing from the printed label and apply it to your prepared surface. Press firmly to ensure full contact.



Figure 3.1: Example of labels applied to kitchen canisters, demonstrating clear organization.



Figure 3.2: Labels used to organize a fishing tackle box, showcasing the versatility of the tape for various items.

4. MAINTENANCE AND STORAGE

Brother P-touch TZE-231 tape is designed for durability and requires minimal maintenance once applied. Proper storage of unused tape cassettes is important to maintain their quality.

Storage Guidelines:

- Store tape cassettes in their original packaging or a clean, dry environment away from direct sunlight and extreme temperatures.
- Avoid exposing tape to excessive humidity or dust, which can affect adhesive quality and print performance.
- Do not attempt to disassemble the tape cassette, as this may damage the tape and void any potential warranty.

5. TROUBLESHOOTING

The Brother P-touch TZE-231 tape is a reliable product. Most issues encountered during label creation are

typically related to the label maker itself rather than the tape. If you experience problems such as poor print quality, tape jams, or labels not adhering properly, consider the following:

- **Print Quality Issues:** Check if the print head of your label maker is clean. Refer to your label maker's manual for cleaning instructions. Ensure the tape cassette is correctly installed.
- **Tape Jams:** Verify that the tape cassette is properly seated. Do not force the tape. If a jam occurs, remove the cassette and clear any obstructions.
- **Adhesion Problems:** Re-evaluate the surface preparation. Ensure the surface is clean, dry, and smooth. For highly textured or difficult surfaces, consider Brother's specialty tapes like Extra Strength Adhesive (TZe-S series).
- **Tape Not Feeding:** Check if the tape is twisted or tangled within the cassette. Ensure the ribbon is turned clockwise until tight (1-2 turns) before use, as indicated on the cassette.

For comprehensive troubleshooting, consult the user manual specific to your Brother P-touch Label Maker model or visit the official Brother support website.

6. SPECIFICATIONS

Attribute	Specification
Brand	Brother
Model Number	TZe231
Tape Width	1/2" (0.47") / 12mm
Tape Length	26.2 ft (8m)
Print Color	Black
Tape Color	White
Material Type	Laminated
Application	Indoor & Outdoor Use
Resistance	Water, Fade, Chemical, Abrasion, Temperature (Freezing to Boiling)
Item Weight	1 ounce
Product Dimensions	5.6 x 0.8 x 5.8 inches





7. WARRANTY AND SUPPORT

For information regarding the warranty of your Brother Genuine P-touch TZE-231 Tape, please refer to the product packaging or the official Brother website. Brother provides comprehensive support for its products.

Contacting Support:

- Visit the official [Brother Store on Amazon](#) for product information and resources.
- Consult the support section of the main Brother website for FAQs, driver downloads, and contact information for technical assistance.

Related Documents - TZe231

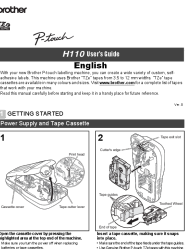
 <p>Brother Tape Technology</p> <p>brother</p>	<p>Brother Tape Technology: Laminated Label Solutions and Durability</p> <p>Explore Brother's advanced laminated tape technology, featuring preloaded cartridges, durable label construction, and a wide range of adhesive types for commercial and industrial applications. Learn about tape durability test results, UL recognition, and specific product specifications.</p>
 <p>brother</p> <p>Étiqueteuse P-touch CUBE Professionnelle</p> <p>PT-E920BT</p>	<p>Brother PT-E920BT P-touch CUBE Pro : Étiqueteuse Professionnelle Portable</p> <p>Découvrez l'étiqueteuse professionnelle portable Brother PT-E920BT P-touch CUBE Pro. Imprimez des étiquettes durables jusqu'à 36mm de largeur avec QR codes, codes-barres et logos. Connectivité Bluetooth et USB-C, batterie rechargeable.</p>
 <p>brother</p> <p>P-touch</p> <p>PT-E110 User's Guide</p> <p>English</p>	<p>Brother PT-E110 P-touch Electronic Labeling System User's Guide</p> <p>This user's guide provides essential information for operating the Brother PT-E110 P-touch electronic labeling system. Discover how to create custom, self-adhesive labels for various needs, including setup, basic usage, advanced features, and troubleshooting. Learn about compatible TZe and HGe tapes and find support resources.</p>
 <p>brother</p> <p>Brother P-touch PT-E510VP</p> <p>Étiqueteuse industrielle portable</p> <p>Impression à 600 points de largeur jusqu'à 24 mm de largeur</p>	<p>Brother P-touch PT-E510VP Industrial Label Maker - Technical Specifications</p> <p>Detailed technical specifications for the Brother P-touch PT-E510VP, a wireless industrial portable label maker. Learn about its features, media compatibility, software, and performance for creating durable labels up to 24mm wide.</p>
 <p>brother</p> <p>P-touch</p> <p>H110 User's Guide</p> <p>English</p> <p>GETTING STARTED</p> <p>Power Supply and Tape Cassette</p> <p>1</p> <p>2</p>	<p>Brother P-touch H110 User Guide: Creating Labels</p> <p>Learn how to use your Brother P-touch H110 labeling machine to create custom, self-adhesive labels. This guide covers setup, basic usage, formatting, and troubleshooting.</p>

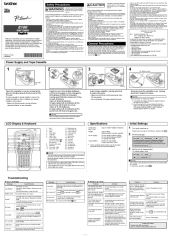

[Brother P-Touch E100 User Guide](#)

A comprehensive user guide for the Brother P-Touch E100 label maker, covering setup, basic usage, templates, useful functions, and troubleshooting.